



L'**acqua** che scorre ha bisogno di **noi**.

accessori idrosanitari

profilo aziendale

company profile



Unità centrale di via Morena 30/4

■ ■ ■ La F.lli Fiore srl è una giovane e dinamica azienda che ha saputo svilupparsi offrendo qualità e sicurezza grazie alla stima acquisita presso i migliori Operatori del settore idrosanitario.

La nostra azienda, che opera su due grandi unità produttive, si avvale della più moderna tecnologia in grado di garantire alti standard qualitativi a costi contenuti.

Pronta a soddisfare ogni particolare esigenza produttiva grazie alla sua grande flessibilità, la F.lli Fiore srl intende ringraziare la sua attuale Clientela e proporsi a nuovi Operatori.

F.lli Fiore srl is a young and dynamic company that has developed offering quality and safety thanks to the appreciation acquired by the best Operators in the sanitary field.

Our company operates on two big production units and makes use of cutting edge technology able to ensure high quality standards and moderate costs.

F.lli Fiore srl is ready to meet all production requirements thanks to its flexibility. The company would like to thank its current customers and propose itself to new Operators.

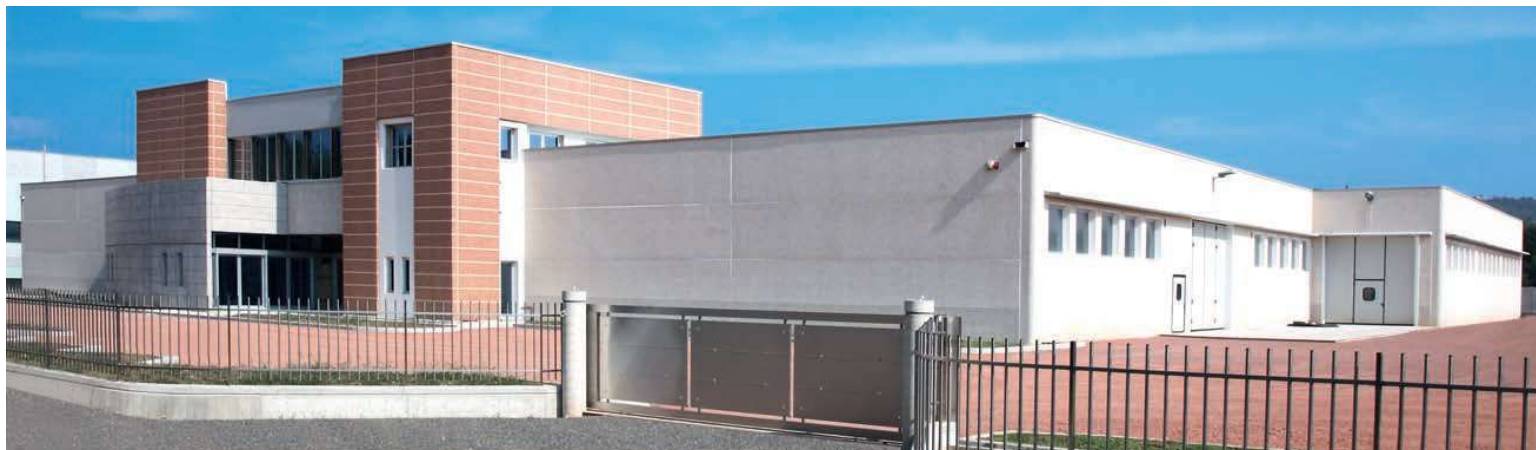

Nuovo stabilimento via Martiri delle Foibe 19



■ canotti sleeves	pag. 06
■ curve bends / elbows	pag. 07
■ sifoni trap	pag. 08
■ accessori fittings	pag. 10
■ rosoni washer	pag. 11
■ tubetti rame copper pipe	pag. 13
■ accessori in rame copper fittings	pag. 14
■ curvette small elbows	pag. 16
■ tubi scarico drain pipes	pag. 17
■ bracci doccia shower arms	pag. 19
■ docce in tubo pipe showers	pag. 23
■ soffioni shower nozzles	pag. 26
■ minuteria joinery	pag. 27
■ bocche universali multipurpose spouts	pag. 29
■ bocche speciali special spouts	pag. 30
■ rompigetto jet-breaker	pag. 31
■ bocche con piantano spouts with upright	pag. 32
■ bocche complete complete spouts	pag. 33
■ bocche simulfuse cast similar pipes	pag. 36



art. CN01

Canotto liscio
Plain sleeve

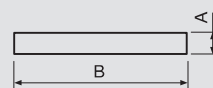

A = Ø 26 - 30 - 32 - 40
B = mm 200 - 250 - 300 - 1.000

art. CN02

Canotto con orlo
Flanged sleeve

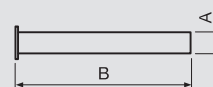

A = Ø 26 - 30 - 32 - 40
B = mm 200 - 250 - 300

art. CN03

Canotto imbutito
1" x 1 1/4 - 1 1/4 x 1 1/2
Spun sleeve
1" x 1 1/4 - 1 1/4 x 1 1/2

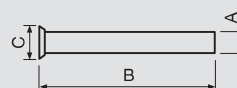

A = Ø 26 **C** = 1 1/4
A = Ø 32 **C** = 1 1/2
B = mm 75 - 120 - 200 - 250 - 300

art. CN04

Canotto in ottone rigato
Knurled sleeve



A = Ø 26 - 30 - 32
B = mm 250 - 300

art. CN05

Tubo mod. "S"
eccentrico Ø26/30/32
Tube mod. "S"
eccentric type Ø26/30/32

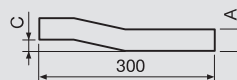

A = Ø 26 **C** = 26 mm
A = Ø 30-32 **C** = 35 mm

art. CN06

Tubo a pipa
Outlet pipe

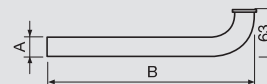

A = Ø 26 - 30 - 32
B = mm 200 - 250 - 300

CURVE

bends / elbows



art. CN07CRV

Curvetta per scarico lavatrice
in PVC cromato
Drain pipe for washing machine



art. CN07

Canotto scarico lavatrice
Drain pipe for washing machine



A = Ø 26 - 30 - 32

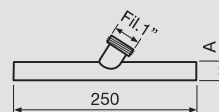

art. CR01

Curva 45° cromata
45° chromed/plated elbow



BxC = 120x140
BxC = 140x160

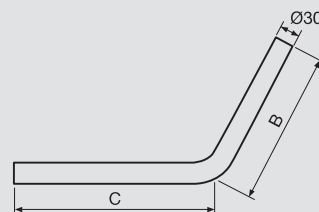

art. CR02

Curva 90° standard
90° elbow standard



A = Ø 25 - 26 - 30 - 32
BxC = 150x250
BxC = 200x300

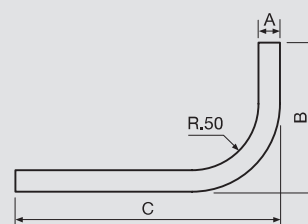

art. CR03

Curva 90° raggio stretto
Ø 30 90° elbow sharp radius



A = Ø 25 - 26 - 30 - 32
BxC = 150x250
BxC = 200x300

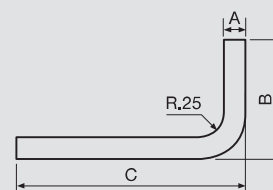

art. SF01

Sifone a bottiglia
Bottle syphon

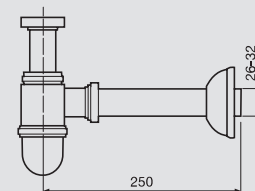

SF01.1

SF01.2

sifone 1"

sifone 1"1/4

art. SF02

Sifone con tappo posteriore
Syphon with posterior stopper

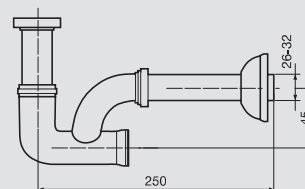

SF02.1

SF02.2

sifone 1"

sifone 1"1/4

art. SF03

Sifone con tappo laterale
Syphon with lateral stopper

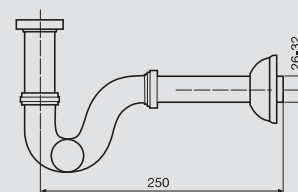

SF03.1

SF03.2

sifone 1"

sifone 1"1/4

art. SF04

Sifone minimale 1"1/4
Minimal syphon 1"1/4

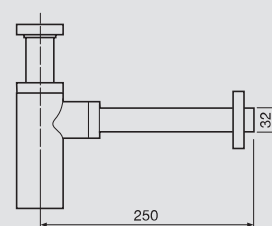

art. SF05

Sifone curvo in tubo 1"1/4
Curved tube syphon 1"1/4

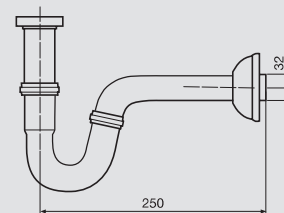

art. SF06

Sifone snodabile in tubo
1"1/4 per bidet
*Articulated syphon in tube
1"1/4 for bidet*

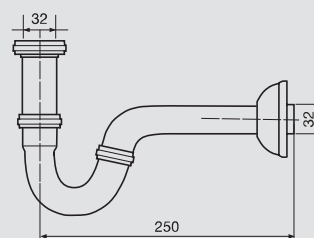

art. SF07

Sifone snodabile in tubo 1"
fisso senza battuta
*Articulated syphon in tube 1"
fixed without beaten*

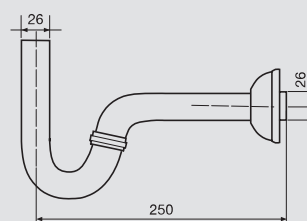

art. TU05

Prolunga per tubo
Extended pipe

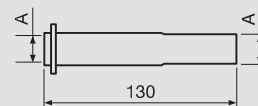

TU05.26	TU05.30	TU05.32
A = Ø 26	A = Ø 30	A = Ø 32

art. MI03

Riduzione
Ø40/32 e Ø32/26
Adapter
Ø40/32 and Ø32/26

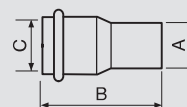

MI03.01	MI03.02
A = Ø 26 B = 70 mm C = Ø 32	A = Ø 32 B = 82 mm C = Ø 40

art. MI19

Riduzione doppio O-RING
Ø40/32 e Ø32/26
Adapter
Ø40/32 and Ø32/26

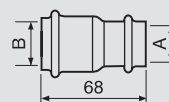

MI19.01	MI19.02
A = Ø 26 B = Ø 32	A = Ø 32 B = Ø 40

art. MI18

Manicotto per raccordo
tubo Ø26/30/32
Pipe connection
Ø26/30/32

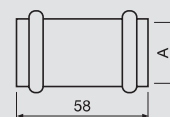

MI18.26	MI18.30	MI18.32
A = Ø 26	A = Ø 30	A = Ø 32

art. MI06

Rosone WC Ø26/30/32
WC washer Ø26/30/32



B = Ø 26 - 30 - 32

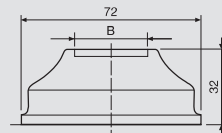

art. MI06.01

Rosetta ottone 1/2"
1/2" brass washer

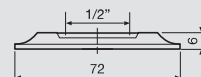

art. MI07

Rosone conico Ø26/30/32/40
Conical washer Ø26/30/32/40



B = Ø 26 - 30 - 32 - 40

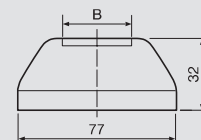

art. MI07.01

Rosetta sottolavabo bombata
Under sink round washer



B = Ø 10 - 12 - 14

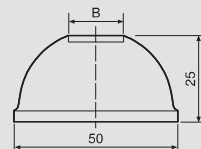

art. MI08

Rosone foro ovale scatolato
Washer oval boring

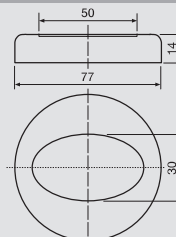

art. MI09

Rosone foro ovale basso
Washer lower type oval boring

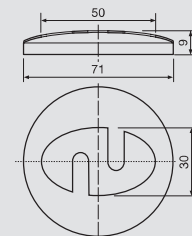

art. MI09.02

Rosone gigante
Big washer



B = Ø 26 - 30 - 32 - 40

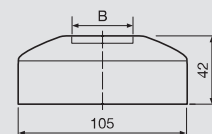



tubetti rame

copper pipe



art. CN08

Attacchino
con cartella saldata
*Copper pipe
welded*

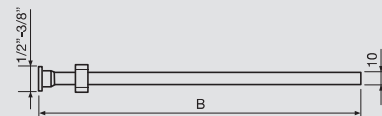

B = mm. 300 - 350 - 400 - 500

art. CN09

Attacchino con cartella
semplice stampata
*Copper pipe normal
type forged*

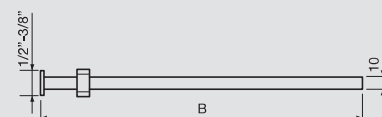

B = mm. 300 - 350 - 400 - 500

art. CN10

Attacchino completo
con cartella semplice
*Complete copper pipe
normal type*

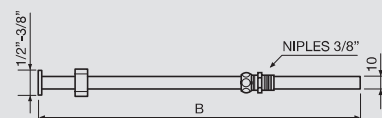

B = mm. 300 - 350 - 400 - 500

art. CN11

Tubetto per
monocomando 10x1
*Tube for single control
10x1*

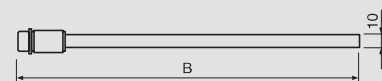

B = mm. 300 - 350 - 400

art. CN11.PRL

Prolunga per tubetto
monocomando
*Extension for single
control tube*

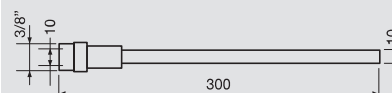

accessori in rame

copper fittings



art. CR04

Squadretta Ø12/14 completa
(con nipples e rosone)
Bracket for under washbasin
with nipples and washe

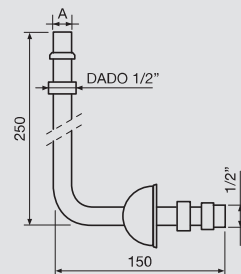

CR04.12	CR04.14
A = Ø 12	A = Ø 14

art. CR05

Squadretta Ø12/14 "nuda"
Bracket Ø12/14 only

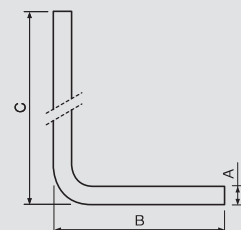

CR05.12	CR05.14
A = Ø 12	A = Ø 14
BxC = 150x250	BxC = 200x300
BxC = 200x300	BxC = 150x250

art. CR06

Minuteria per squadretta
Bracket parts



art. TU06

Tubo in rame rotolo 5 mt.
m. 5 coil copper pipe



TU06.10	TU06.12	TU06.14
Ø 10 mm	Ø 12 mm	Ø 14 mm

accessori in rame

copper fittings



art. CR11.01

Tubetto per cassetta
Pipe for water tank

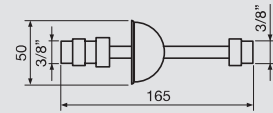

art. CR11.02

Tubetti per rubinetto cassetta
Pipe for tap water tank

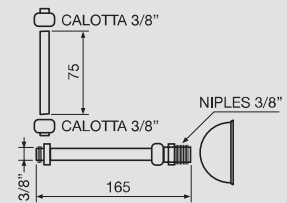

art. CR12.01

Curveta attacco muro stampata
Wall connected elbow cast

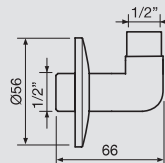

art. TU07

Tubetto rame cromato 1000/1500 mm
Copper tube 1000/1500 mm



TU07.10X100	TU07.10X150	TU07.12X100	TU07.12X150	TU07.14X100	TU07.14X150
A = Ø 10 B = mm 1000	A = Ø 10 B = mm 1500	A = Ø 12 B = mm 1000	A = Ø 12 B = mm 1500	A = Ø 14 B = mm 1000	A = Ø 14 B = mm 1500

curvette

small elbows



■ art. CR07.01

Curvetta sottolavabo fissa
Fixed under-washbasin elbow

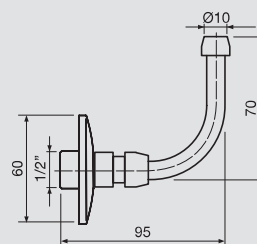

■ art. CR08.01

Curvetta sottolavabo scorrevole
Slider under-washbasin elbow

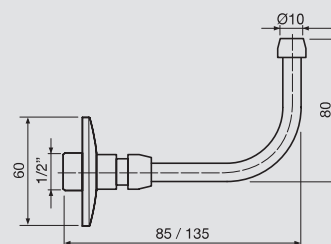

■ art. CR09.01

Curvetta sottolavabo scorrevole 45°
45° slider under-washbasin elbow

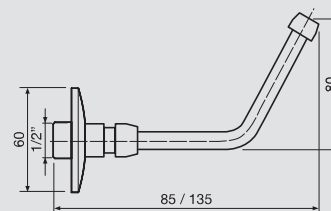

■ art. CR10.01

Curvetta sottolavabo stampata in pezzo unico
Printed cast under-washbasin elbow



■ art. CR10.02

Curvetta sottolavabo stampata smontabile
Printed removable under-washbasin elbow



■ art. MI11.01

Rubinetto sottolavabo con filtro
Under-basin valve with filter



■ art. MI11.02

Rubinetto sottolavabo con filtro e snodo
Under-basin valve with filter and junction



tubi scarico

drain pipes



art. TU01

Tubo a "L"
Tube mod. "L"

A = Ø 25 - 26 - 28 - 30 - 32
B = a richiesta
C = a richiesta

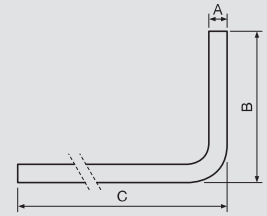

art. TU02

Tubo per passo rapido 3/4" - 1"
Tube for quick-pitch tap 3/4" - 1"

TU02.01	TU02.02
A = Ø 25	A = Ø 30

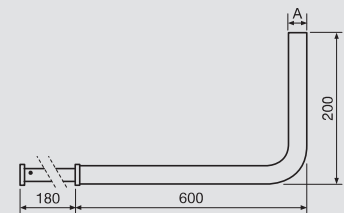
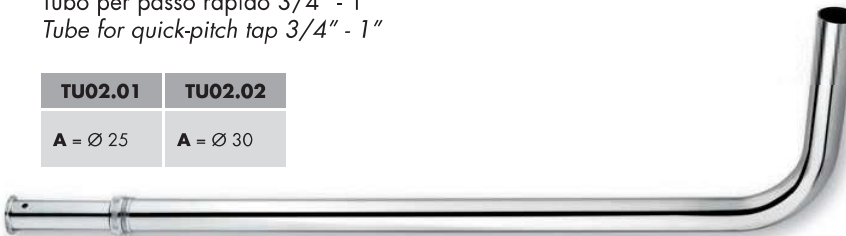

art. TU03

Tubo per passo rapido - incasso in rame
Tube for quick-pitch tap - built-in copper



art. TU04

Tubo per passo rapido 3/4" o 1" basso
Tube for quick-pitch tap 1" lower type

TU.04.01	TU.04.02
A = Ø 25	A = Ø 30

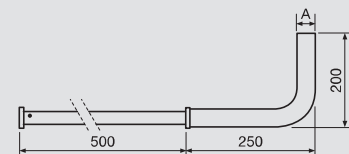

art. TU08

Tubo scarico cassetta PVC
Tube download box PVC

TU08.01	TU08.02
A = Ø 32	A = Ø 40

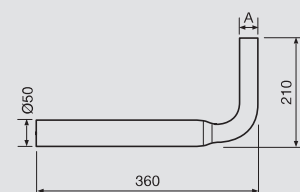



bracci doccia

shower arms



art. BR01

Braccio $\text{\O}16 \times 90^\circ$
Shower arm $\text{\O}16 \times 90^\circ$



BR01.20	BR01.25	BR01.30	BR01.40
B = mm 200	B = mm 250	B = mm 300	B = mm 400

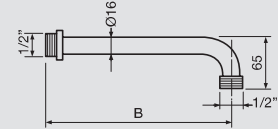

art. BR02

Braccio $\text{\O}16 \times 45^\circ$
Shower arm $\text{\O}16 \times 45^\circ$



BR02.10	BR02.20
B = mm 140	B = mm 200

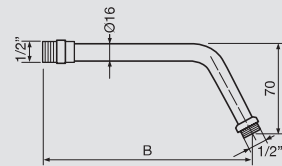

art. BR03

Braccio $\text{\O}20 \times 90^\circ$
Shower arm $\text{\O}20 \times 90^\circ$



BR03.20	BR03.25	BR03.30	BR03.40
B = mm 200	B = mm 250	B = mm 300	B = mm 400

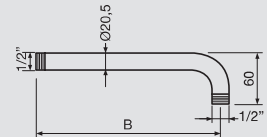

art. BR04

Braccio $\text{\O}20 \times 45^\circ$
tipo americano
American shower arm $\text{\O}20 \times 45^\circ$



BR04.14	BR04.20
B = mm 140	B = mm 200

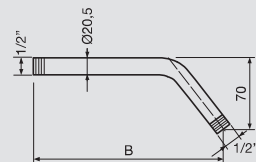

art. BR04.02

Braccio doccia $\text{\O}20$
a soffitto
Shower arm $\text{\O}20$



BR04.02.20	BR04.02.30	BR04.02.40
B = mm 200	B = mm 300	B = mm 400

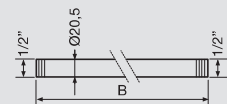

art. BR05

Braccio fisso $\text{\O}18$
 $1/2'' \times 1/2''$
Fixed shower arm $\text{\O}18$ $1/2'' \times 1/2''$



BR05.20	BR05.25	BR05.30	BR05.40
B = mm 200	B = mm 250	B = mm 300	B = mm 400

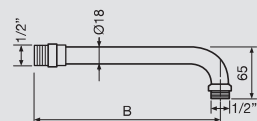

bracci doccia

shower arms



art. BR06.01

Braccio Ø18x45°
Short shower arm Ø18x45°

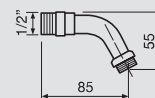

art. MI06.02

Rosetta acciaio con falso filetto 1/2"
Steel round washer with false thread 1/2"

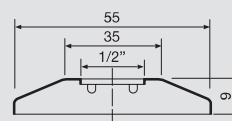

art. MI06.03

Rosetta ottone pesante con filetto 1/2"
Heavy brass round washer with thread 1/2"

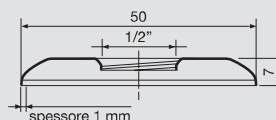

art. BR07

Braccio sfera
Spherical arm

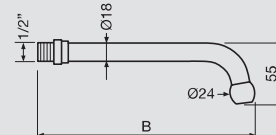

BR.07.18X20	BR.07.18X25	BR.07.18X30	BR.07.18X40
-------------	-------------	-------------	-------------

B = mm 200	B = mm 250	B = mm 300	B = mm 400
------------	------------	------------	------------

art. BR07.CS

Braccio sfera con soffione
Ø18x200/250/300/400 mm
Spherical shower arm
Ø18x200/250/300/400 mm

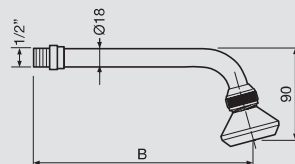

BR07.18X20CS	BR07.18X25CS	BR07.18X30CS	BR07.18X40CS
--------------	--------------	--------------	--------------

B = mm 200	B = mm 250	B = mm 300	B = mm 400
------------	------------	------------	------------

art. BR08

Braccio inglese tipo
incasso
English shower arm

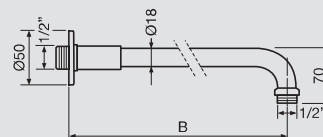

BR08.30	BR08.35	BR08.40	BR08.45	BR08.50
---------	---------	---------	---------	---------

B = mm 300	B = mm 350	B = mm 400	B = mm 450	B = mm 500
------------	------------	------------	------------	------------

bracci doccia

shower arms



art. BR09

Braccio inglese attacco a tre fori 1/2" o 3/4"
English arm with 3 hole connection

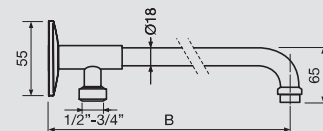

BR09.30	BR09.35	BR09.40	BR09.45	BR09.50
B = mm 300	B = mm 350	B = mm 400	B = mm 450	B = mm 500

art. BR08.01

Braccio doccia "vecchio stile" pesante
"Old style" heavy shower arm

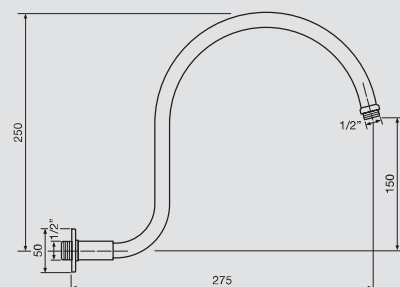

art. BR11.01

Braccio doccia "vecchio stile"
"Old style" shower arm

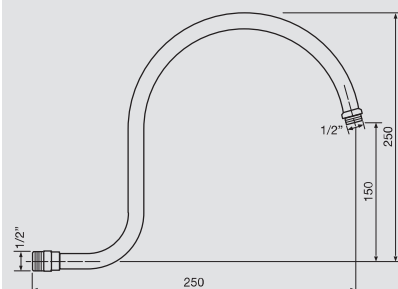

art. BR10.01

Braccio doccia fuso conico
Cast shower arm conical

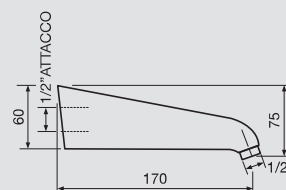

art. BR12.01

Braccio doccia fuso tipo "Vesuvio"
Cast shower arm mod. "Vesuvio"

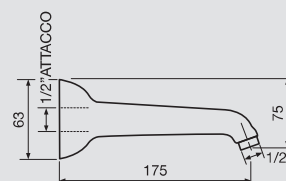

bracci doccia

shower arms



art. BR13

Braccio diritto Ø24
Right shower arm Ø24



BR13.30	BR13.35
A = mm 300	A = mm 350

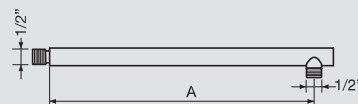

art. BR14

Braccio diritto quadro
22x22
Right shower arm 22x22



BR14.30	BR14.35
A = mm 300	A = mm 350

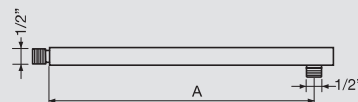

art. BR15

Braccio curvo quadro 22x22
Curved shower arm 22x22



BR15.30	BR15.35
A = mm 300	A = mm 350

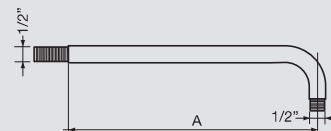

art. BR16

Braccio doccia in tubo
rettangolare 40x15
Rectangular shower arm
40x15



BR16.30	BR16.35
A = mm 300	A = mm 350

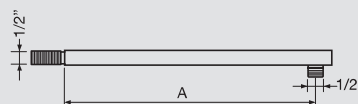

art. BR14.RSQ

Rosone per braccio
quadro 22x22
Washer for square
shower arm 22x22

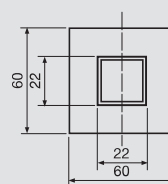

docce in tubo

pipe showers



■ **art. BR22**

Colonna doccia Ø18
Shower pipe Ø18

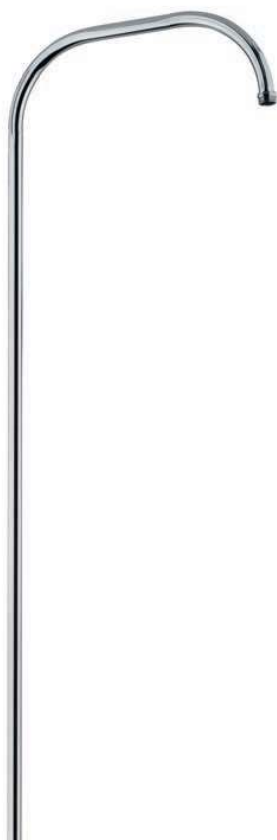

■ **art. BR22.GNC**

Gancio in ABS
per colonna Ø18
Hook in ABS
for Ø18 column



■ **art. BR23**

Colonna doccia Ø16
Shower pipe Ø16

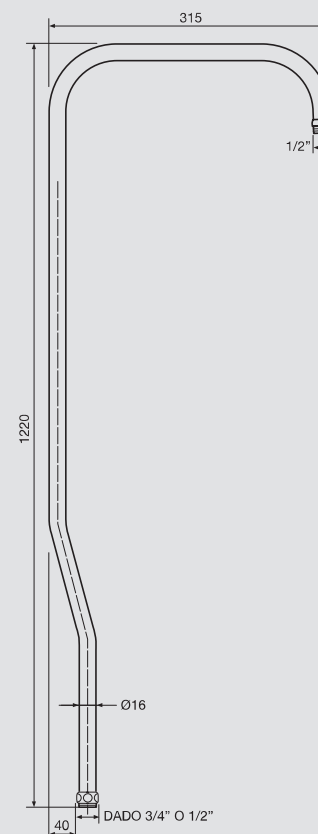

■ **art. BR23.GNC**

Gancio per colonna Ø16
Hook for Ø16 column



docce in tubo

pipe showers



art. BR24

Colonna doccia Ø16
 modello "PONTE"
 Shower pipe Ø18
 mod. "BRIDGE"



art. BR23.GNC

Gancio per colonna Ø16
 Hook for Ø16 column

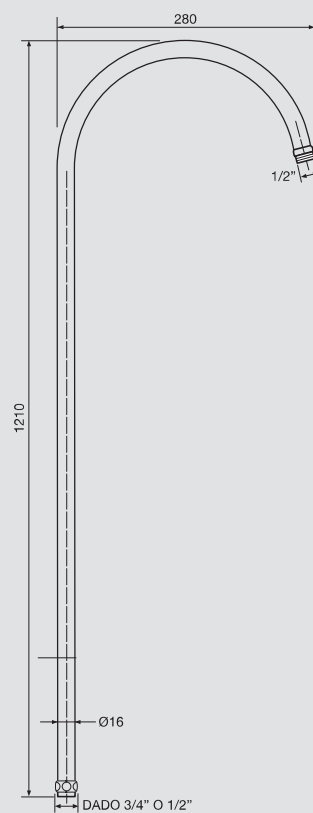

art. BR25.01

Colonna doccia
 "LUSSO" telescopica
 "LUXURY" telescopic
 column shower

BR25.01.P	BR25.01.L
mod. PONTE	mod. "L"

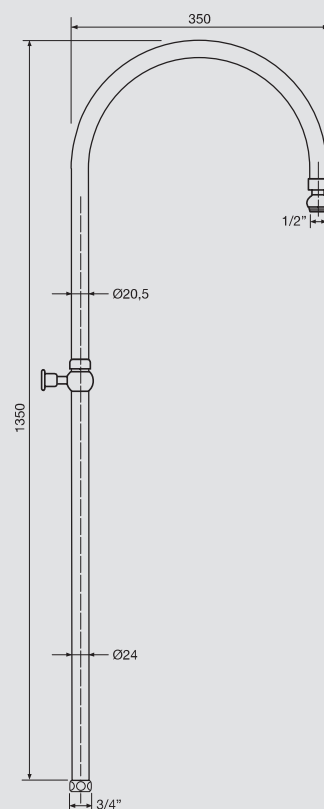

docce in tubo

pipe showers



art. BR25.02

Colonna doccia
"LUSSO" fissa
"LUXURY" fixed
column shower

BR25.02.P	BR25.02.L
mod. PONTE	mod. "L"

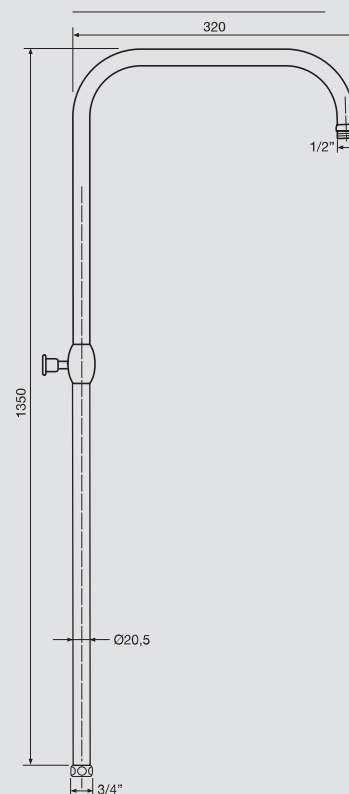

art. BR19

Soffione in lastra
d'ottone Ø160
Brass shower head
Ø160

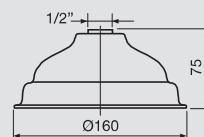

art. **BR20**

Soffione in acciaio
 Ø80/90
 Shower head in stainless
 steel Ø80/90

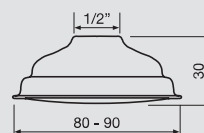

BR20.01	BR20.02
Ø 80	Ø 90

art. **BR021.01**

Soffione in acciaio Ø85
 mod. "Campana"
 Shower head in stainless
 steel Ø85 mod. "Bell"

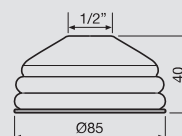

art. **MI12.01**

Soffione doccia americano
 con snodo
 American shower head

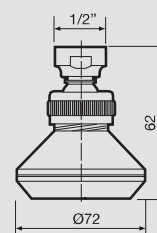

art. **MI13.01**

Soffione in lastra
 con snodo
 Shower head

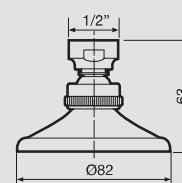

art. **MI14.01**

Soffione in ottone conico
 con snodo
 Conical brass shower
 head

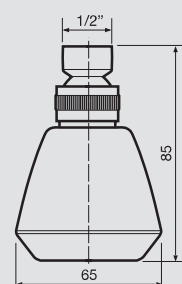

art. MI15.01

Niples completo
per monoforo
*Complete nipples
for one-hole mixer*



MI15.01	MI15.02
1/2"x3/8"	1/2"x1/2"

art. MI16

Dado 1/2" - 3/8" con
foro 10-12-14
*Nut 1/2" - 3/8" with
hole 10-12-14*



MI16.01	MI16.02
1/2"	3/8"

art. MI17

Dado 1" - 1" 1/4
Nut 1" - 1" 1/4



MI17.01	MI17.02
1" F. 26	1"1/4 F. 30-32

art. MI18.01

Tappo copriforo
1/2" Ø67 mm
*Hole stopper
1/2" Ø67 mm*



art. MI50

Particolari per canne
Parts for pipes



- A** Calotta 3/4" F. 18,5 **MI50.01**
- B** Hostaform **MI50.02**
- C** OR 10 **MI50.03**
- D** Cappuccio 18x3/4" **MI50.04**



bocche universali

multipurpose spouts



art. CA01

Canna Ø18 mod. "S"
 attacco univ. 3/4"
 Ø18 "U" spout univ. 3/4"



CA01.10	CA01.15	CA01.20	CA01.25	CA01.30	CA01.35	CA01.40
A = 100	A = 150	A = 200	A = 250	A = 300	A = 350	A = 400

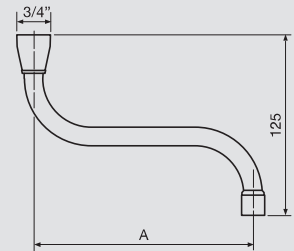

art. CA02

Canna Ø18 mod. "U"
 attacco univ. 3/4"
 Ø18 "U" spout univ. 3/4"



CA02.15	CA02.20	CA02.25	CA02.30	CA02.35	CA02.40
A = 150	A = 200	A = 250	A = 300	A = 350	A = 400

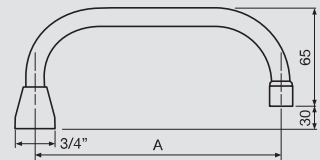

art. CA03.01

Canna Ø18 mod. "Jota corta"
 150 mm. univ.
 Ø18 "J" spout short type univ.
 150 mm.

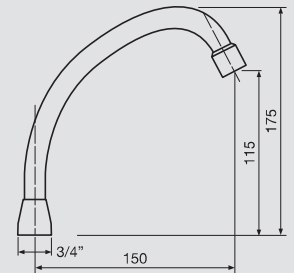

art. CA04.01

Canna Ø18 mod. "Jota lunga"
 200 mm. univ.
 Ø18 "J" spout long type univ.
 200 mm.

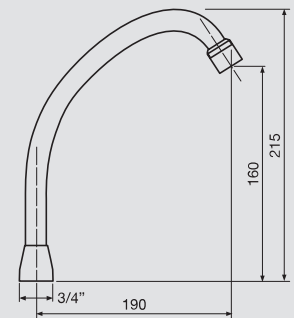

art. CA05.01

Canna Ø18 mod. "Ponte"
 grande univ.
 Ø18 spout mod. "Bridge"
 univ.

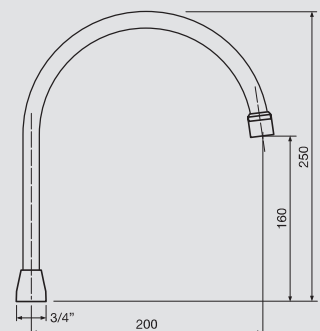

bocche speciali

special spouts



art. CA07.01

Canna telescopica allungabile, attacco 3 gole o universale
Adjustable spout

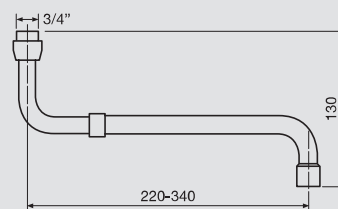

art. CA08.01

Testina rovesciabile universale 3/4"
Adjustable spout head

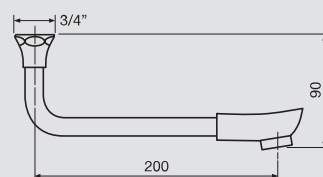

art. CA09

Canna Ø14 mod. "S"
attacco univ. 1/2"
Ø14 "S" spout univ. 1/2"

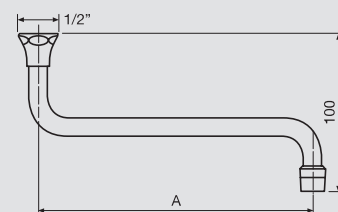
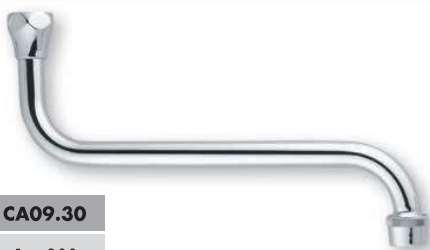

CA09.15	CA09.20	CA09.25	CA09.30
A = 150	A = 200	A = 250	A = 300

art. CA10.01

Canna Ø14 mod. "L"
attacco univ. 1/2"
Ø14 "L" spout univ. 1/2"

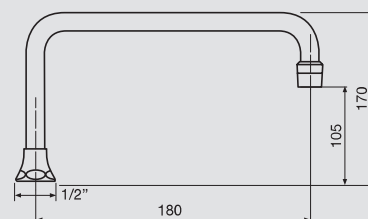

art. CA10.02

Canna Ø14 mod. "Jota corta"
attacco universale 1/2"
Ø14 spout short mod. "J"

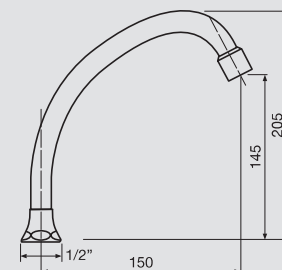

art. CA10.03

Canna Ø14 mod. "Jota lunga"
attacco universale 1/2"
Ø14 spout long mod. "J"

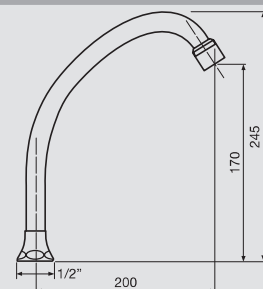

■ **art. MI01.01**

Rompigetto in plastica cromato, filetto 22x1F
Chrome plated plastic jet-breaker, version 22x1F



■ **art. MI02.01**

Rompigetto in ottone, filetto 22x1F
Brass jet-breaker, version 22x1F



■ **art. MI04.02**

Rompigetto antivandali 24x1M
Jet-breaker antitheft version 24x1M



■ **art. MI04.01**

Rompigetto antivandali 22x1
Jet-breaker antitheft version 22x1



■ **art. MI05.01**

Areatore in ottone, filetto 22x1 e 24x1
Brass areator, version 22x1 and 24x1



MI05.01	MI05.02
22x1 femmina	24x1 maschio

bocche con piantana

spouts with upright



art. BP01.00

Piantana pesante con bocca
simil-fusa 200 mm
*Upright with cast similar
spout 200 mm*

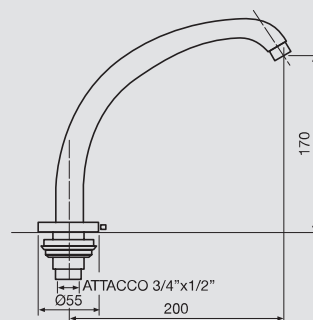

art. BP02.00

Piantana pesante con bocca
simil-fusa 150 mm
*Upright with cast similar spout
150 mm*

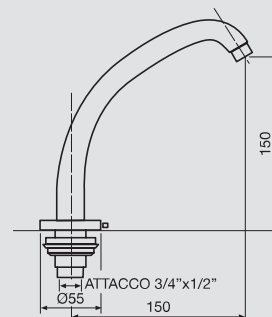

art. BP03

Piantana pesante con canna
"ponte grande" Ø22 - 25
*Upright with "big bridge"
pipe Ø22 - 25*

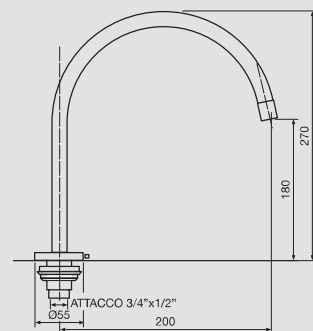

BP03.00	BP03.01
Ø 22	Ø 25

bocche complete

complete spouts



art. BP04.00

Piantana pesante con
bocca Ø25 lavabo
*Upright with washbasin
spout Ø25*

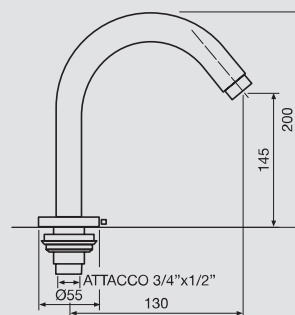

art. BP05

Piantana leggera con
canna "Jota"
Upright with "Jota" spout

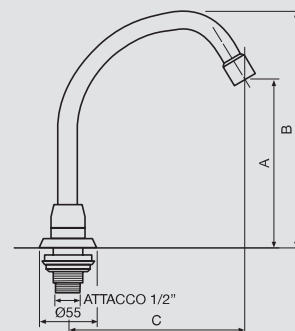

BP05.01	BP05.02
---------	---------

A = 125	A = 155
B = 185	B = 230
C = 150	C = 200

art. BP06.01

Piantana economica canna
"Jota" Ø14 con rompigetto
*Upright with "Jota" spout
Ø14*

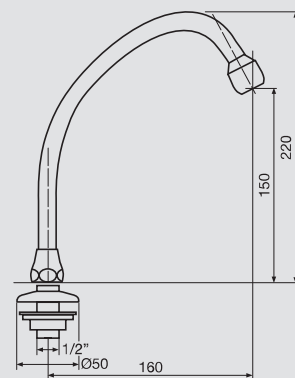

bocche complete

complete spouts



art. CA11

Canna Ø18 mod. "S"
completa 3 gole
Ø18 S-spout complete
3 grooves

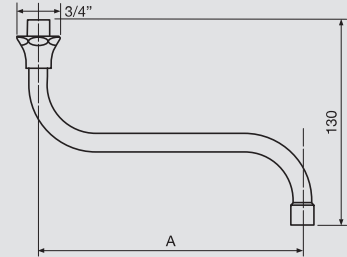

CA11.10	CA11.15	CA11.20	CA11.25	CA11.30	CA11.35	CA11.40
A = 100	A = 150	A = 200	A = 250	A = 300	A = 350	A = 400

art. CA12

Canna Ø18 mod. "U"
completa 3 gole
Ø18 U-spout complete
3 grooves

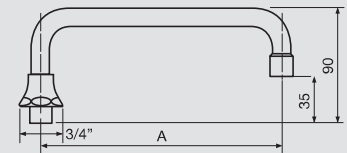

CA12.15	CA12.20	CA12.25	CA12.30	CA12.35	CA12.40
A = 150	A = 200	A = 250	A = 300	A = 350	A = 400

art. CA13.00

Canna Ø18 mod. "Jota
corta" 3 gole completa
Ø18 "J" spout short
3 grooves complete

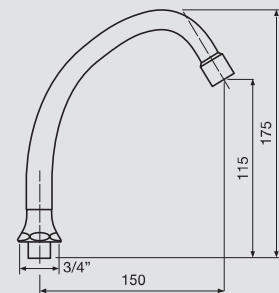

bocche complete

complete spouts



art. CA14.00

Canna Ø18 mod. "Jota
lunga" 3 gole
Ø18 "J" spout long
3 grooves

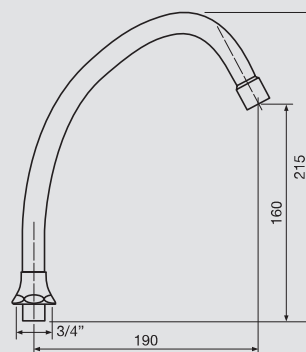

art. CA15

Canna Ø18 mod. "Jota
2 pieghe" 3 gole
Ø18 "J" spout
3 grooves

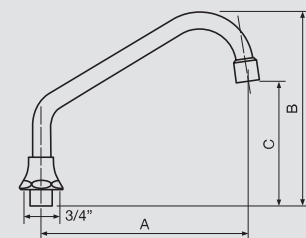

CA15.20	CA15.25	CA15.30
A = 170	A = 250	A = 300
B = 200	B = 250	B = 250
C = 100	C = 145	C = 165

art. CA16.00

Canna Ø18 mod. "Ponte
piccola" per lavabo completa
Ø18 spout bridge type small
washbasin complete

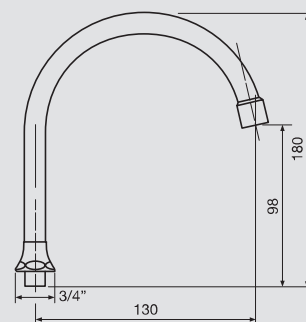

art. CA17.00

Canna Ø18 per bidet
completa
Ø18 bidet spout
complete

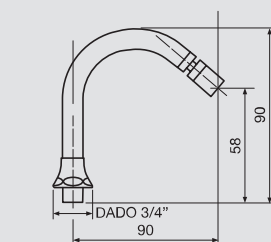

bocche similfuse

cast similar pipes



art. CA18.00

Canna mod. "Ponte grande"
3 gole completa
Spout bridge type big 3
grooves complete

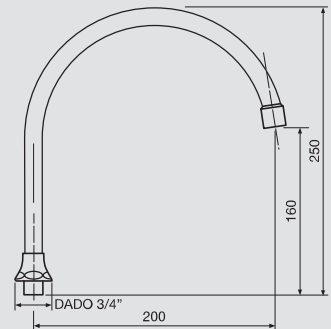

art. CA06.00

Canna Ø18 mod. "L"
3 gole completa
Ø18 "L" spout 3
grooves complete

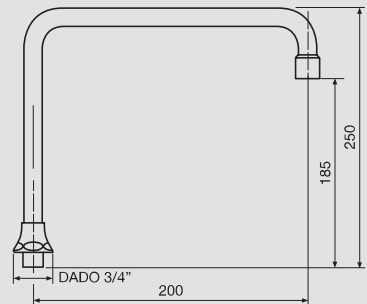

art. CA19

Bocca mix muro completa
Wall mix-spout
complete

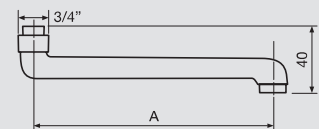

CA19.13	CA19.15	CA19.20	CA19.25	CA19.30	CA19.35	CA19.40
A = 130	A = 150	A = 200	A = 250	A = 300	A = 350	A = 400

art. CA20

Bocca ovale mod. "S"
completa
Oval "S" spout complete

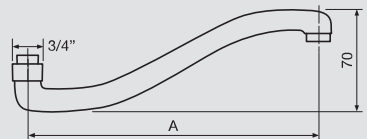

CA20.15	CA20.20	CA20.25	CA20.30
A = 150	A = 200	A = 250	A = 300

bocche similfuse

cast similar pipes



art. CA21

Canna similfusa mod. "L"
completa
"L" spout cast similar complete



CA21.16	CA21.20
A = 160	A = 200

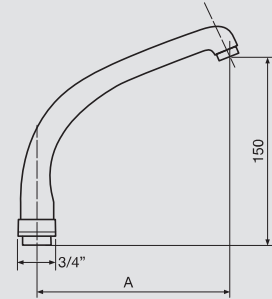

art. CA22.00

Bocca similfusa conica lunga
200 mm completa
*200 mm long spout complete
cast similar*

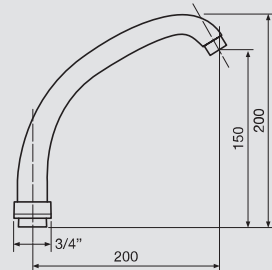

art. CA23.00

Bocca similfusa conica
corta 140 mm completa
*140 mm short spout
cast similar complete*

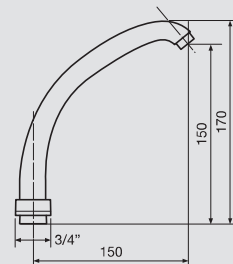

art. CA24

Bocca lavello vecchio stile
completa
*Complete mouth old style
sink*



CA24.01	CA24.02	CA24.03
Bidet A = 135 B = 50	Lavabo A = 185 B = 180	Lavello A = 235 B = 180

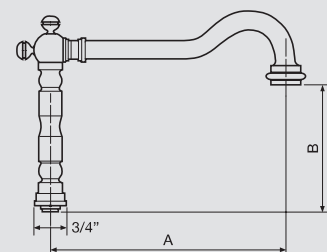

condizioni generali di vendita

sales general terms



ORDINAZIONI

Sono valide solo dopo ns. conferma

PESI, DIMENSIONI E MODELLI

Sono a carattere indicativo e possono essere soggetti a variazioni.

CONSEGNA

Si intende sempre a franco ns. stabilimento.

PAGAMENTI

Devono essere sempre fatti al nostro domicilio di Gozzano. Eventuali emissioni di assegni o tratte, rimesse di cessioni o di accettazioni cambiarie, non implicano annullamento di questa clausola attributiva di giurisdizione. Trascorsi i termini fissati per il pagamento, sulle somme scoperte decorre l'interesse commerciale.

RECLAMI

Sono accettati solo se fatti entro 8 giorni dal ricevimento della merce. Il reclamo sulla quantità non è valido se non fatto al momento della consegna. Tutti i ns. materiali sono accuratamente controllati e collaudati; la nostra responsabilità si limita con l'accettare il ritorno e ricambiare, eventuali pezzi riscontrati difettosi.

CONTROVERSIE

Qualsiasi controversia è dovuta alla Competente Autorità Giudiziaria.

ORDERS

They are valid after our confirmation only.

WEIGHTS, SIZES AND MODELS

They are indicative and may be changed.

DELIVERY

It is always free our factory.

PAYEMENTS

The must always be made to our address in Gozzano. Possible issues of cheques or drafts, remittances of assignments or exchange acceptances do not imply the cancellation of this jurisdiction attributive clause.

When the terms fixed for the payment expire, the commercial interest ha effect on the overdrawn accounts.

COMPLAINTS

They are only accepted if made within 8 days from receipt of goods. Any complaint concerning the quality is valid if made at the time of delivery only. All our goods are carefully checked and tested; our responsibility is limited to accept the return and exchange of defective pieces only.

CONTROVERSIES

Any controversy is trasfered to the Competent Judicial Authority.

come raggiungerci
how to reach us

F.lli FIORE S.R.L.

GOZZANO

BORGOSIESIA
BORGOMANERO
ROMAGNANO SESIA
GHEMME
BIANDRATE
NOVARA
VERCELLI

GRAVELLONA T.
ARONA
CASTELLETTO T.

Lago d'Orta
Lago Maggiore

VARESE
MILANO
GALLARATE
Malpensa

A4
A26
A8

SS142
SS229

TORINO
MILANO

F.lli FIORE srl
Via Martiri delle Foibe, 19
28024 GOZZANO (NO) Italy
Tel. +39 0322 913106
Fax +39 0322 913802
info@fioresrl.it
www.fioresrl.it





Via Martiri delle Foibe, 19
28024 GOZZANO (NO) Italy
Tel. +39 0322 913106
Fax +39 0322 913802
info@fioresrl.it

www.fioresrl.it



Certificato n. 054166/01